

LED-Signal light BLL

General information

Compact signal light in rubber case protected against vibrations, in LED-technology, for various applications, e.g. on machines, vehicles and cranes.

9 high intensity LED with efficient lenses.
Following modes can be selected on the device: steady light, flashing light, strobe light and revolving flash light



Technical data

Case	elastic TPF
Lens	Polycarbonat
- Colours	red, amber, green, blue
Class of protection	II (a compensation of potention is not necessary!)
Degree of protection	IP67 according to EN 60529
Cabel entry	6-8mm, sealed by rubber
Connection	1,5mm ² using one cable
Installation	Vertical
Temperature range	-40°C up to +50°C
Weight	0,45 kg
Operation	continuous

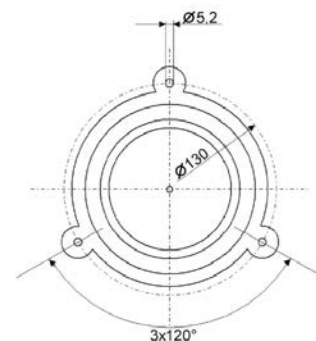
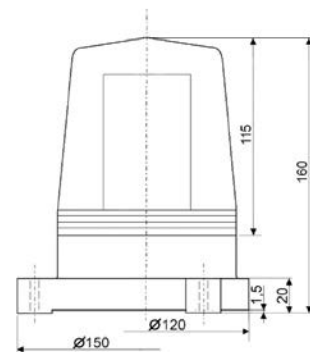

Order data

Number of article	Nominal tension	LED	Current consumption
BLL.024.3*	12/24VDC	3x3 LED's	12V: 1200mA / 24V: 600mA
BLL.115.1*	115VAC	3x3 LED's	140mA
BLL.230.1*	230VAC	3x3 LED's	70mA

*Lens-/LED-colour 1 = red, 2 = amber, 4 = green, 5 = blue

Accessories

M-BLL.000.00 Wall mounting angle, black

Technical data may be changed without prior notice

